

TOORX
PROFESSIONAL LINE

INSTRUCTION



WBX4000



Cod : GRLDTOORXWBX4000

Rev : 00

Ed : 05/18

REGULAR MAINTENANCE

1. The safety level of the equipment can be maintained only if it is examined regularly for damage and wear, e.g. ropes, pulleys, connection points;
2. Pay special attention to components most susceptible to wear.
3. Replace defective components immediately and /or keep t he equipment out of use until repair;
4. This equipment should carry on regular maintenance according to the following chart:

MAINTENANCE	EVERYDAY	EVERY WEEK	THREE MONTHS
Check: connecting, bolt, Weight stack bolt	√		
Clearance: cushion and cover	√		
Lubrication: place of sliding			√
Check: bolt if tighten		√	
Lubrication: Bracket of bearing			√

INSTALL SKETCH MAP

Let assembly become easier

All the content of user's manual is to assured the strength training machine can be installed more easily

Reading the details and instructions before installing:

1. Because the size and weight of equipment is so large, Please choose the installed place near the desired station and assured there is enough space to exercise
2. All parts can be put on the clear area, then backout the wrapper. And the wrapper can't be through away before installation finished.
3. Screw the bolt tightly except the additional instruction
4. All parts must be installed according the illustration indication.
5. Installation work can be finished by tow men
6. Identify all parts by part identify chart

Assmble Step:

Use tool:

- 1. M6 Hex spanner**
- 2. Two 17-19 spanner**
- 3. M5 Hex spanner**
- 4. Two 22-24 spanner**

Exploded Picture

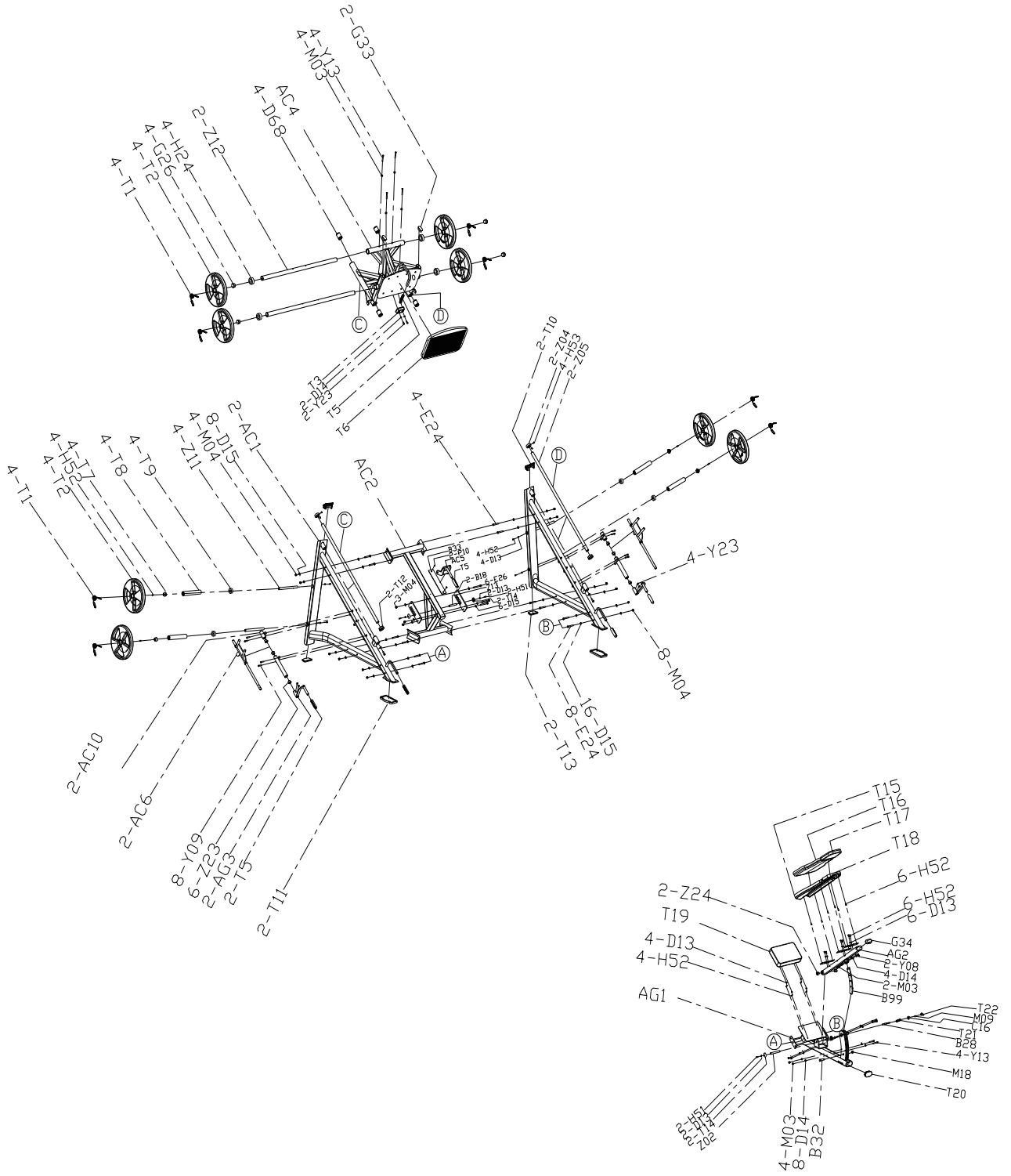

Step t1

NO.	Name	Specification	Qty
Z13	axis	∅13*121	1
D13	washer	M8	6
H51	semicircle head screws hexagon	M8*25	2
T14	bearing cover		2
Z23	copper sheathing		6

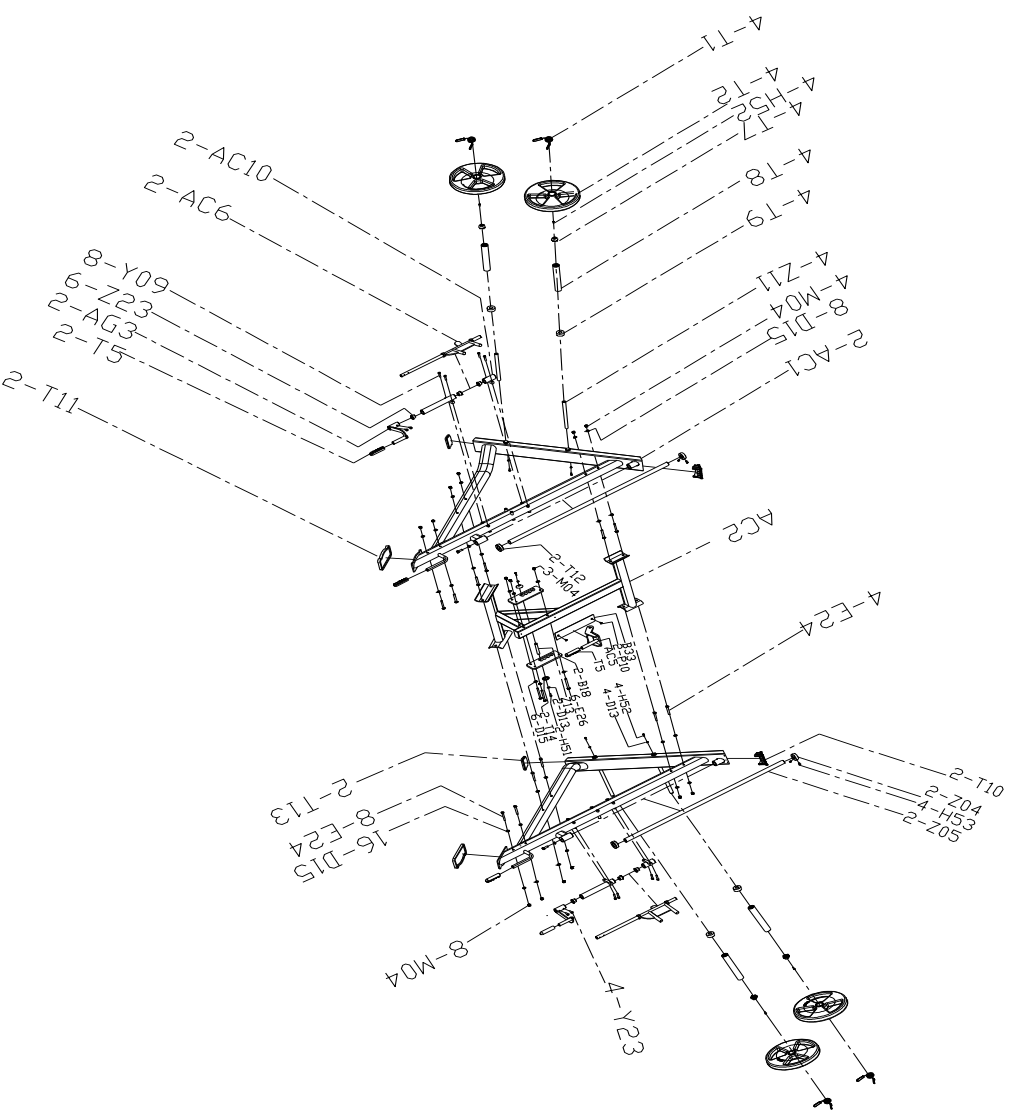

NO.	Name	Specification	Qty
T1	circclip		4
T2	disc	25KG	4
T7	Barrel cover		4
T8	gun barrel	∅50*302	4
T9	cushion	∅60*∅26*25	4
Z11	Barbell piece rod	∅50*1285	4
M04	check nut	M12	15
D15	washer	M12	30
AC1	cardinal shelf		2
AC2	bracing frame		1
E24	hexagon bolt	M12*90	12
T10	pipe close		2
Z04	retainer ring	∅65*∅35.2*20	2
H53	semicircle head screws hexagon	M8*15	4
Z05	optical axis	∅65*1560	2
Y23	socket cap screw	M10*20	4
H52	semicircle head screws hexagon	M8*20	8
T13	foundation		2
T11	foundation		2
T5	Gr ip		3
AC3	Limit hand welding group	12*2.5	2
Y09	socket cap screw	M10*45	8
AC6	Limit combo		2
AC10	Fixing sleeve welding unit		2
T12	cushion	∅68*∅35*20	2
B33	backing		1
P10	countersink screw with socket head	M6*15	2
AC5	Intermediate Insurance		1
B18	adjusting plate		2
E26	hexagon bolt	M12*120	6

Step t.2

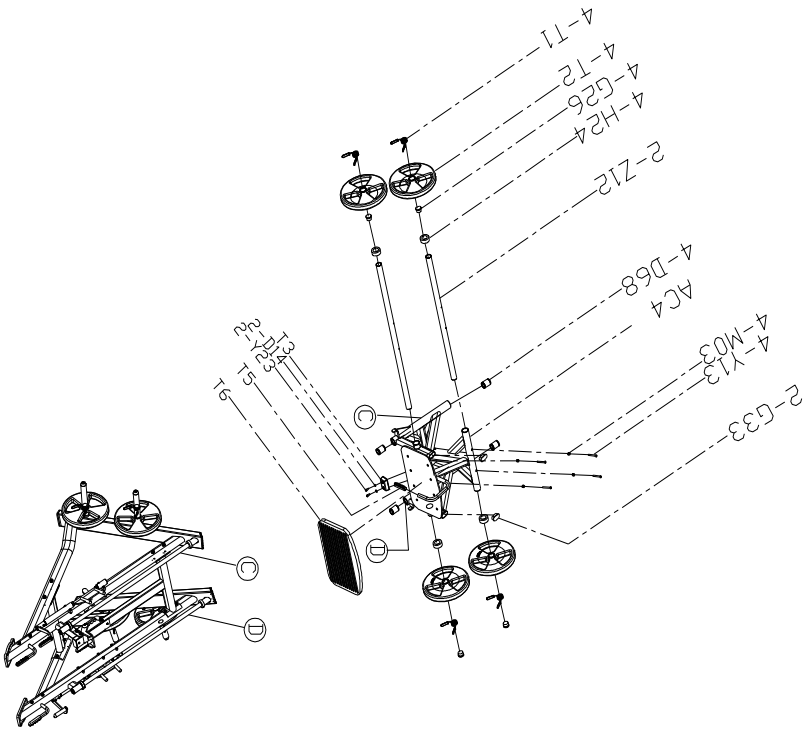

NO.	Name	Specification	Qty
T1	circlip		4
T2	disc	25KG	4
G26	pipe close	?50	4
H24	cushion	?80*?50*30	4
Z12	Hanging rod	?50*1285	2
D68	linear bearing		4
AC4	Trolley combination		1
M03	check nut	M10	4
Y13	socket cap screw	M10*70	4
G33	pipe close		2
T3	beam		1
D14	washer	M10	2
Y23	socket cap screw	M10*20	2
T5	Grip		1
T6	mat		1



GARLANDO SPA
Via Regione Piemonte, 32 - Zona Industriale D1
15068 - Pozzolo Formigaro (AL) - Italy
www.toorx.it - info@toorx.it